



SUNNICA ENERGY FARM

EN010106

8.48 Tree Preservation Order Trees Location Plan

Planning Act 2008

Infrastructure Planning (Examination Procedure) Rules 2010



Planning Act 2008

**Infrastructure Planning
(Examination Procedure) Rules 2010**

Sunnica Energy Farm

8.48 Tree Preservation Order Trees Location Plan

Planning Inspectorate Scheme Reference	EN010106
Application Document Reference	EN010106/APP/8.48
Author	Sunnica Energy Farm Project Team

Version	Date	Status of Version
Rev 00	22 November 2022	Submitted at Deadline 3

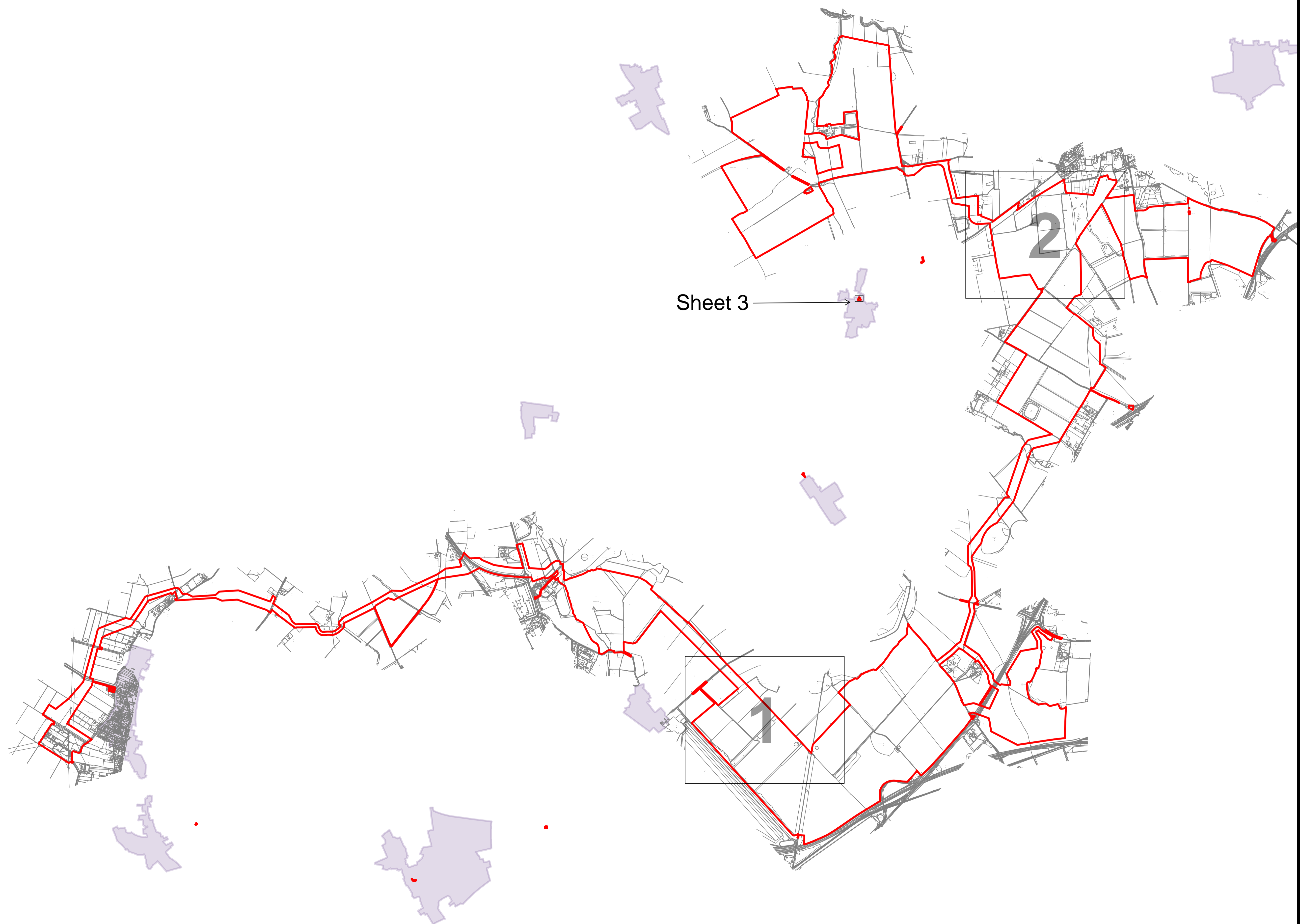

Sheet 3



PROJECT
 SUNNICA ENERGY FARM

CLIENT
 SUNNICA ENERGY FARM

CONSULTANT
 AECOM
 Plumer House, Third Floor,
 East Wing, Tallyour Road
 Plymouth, PL6 5DH
 Tel +44(0)1752 676700
 Fax +44(0)870 238 6023
 www.aecom.com

GENERAL NOTES

1. TREE LOCATIONS ARE BASED ON THE TOPOGRAPHICAL SURVEY, AERIAL IMAGERY, AND GPS CO-ORDINATES FROM ON SITE WALKOVER.
2. PLANS SHOULD BE READ IN CONJUNCTION WITH THE AECOM ARBORICULTURAL REPORT.
3. DRAWING REFERENCES:
 ref_000000.dwg

KEY PLAN



KEY

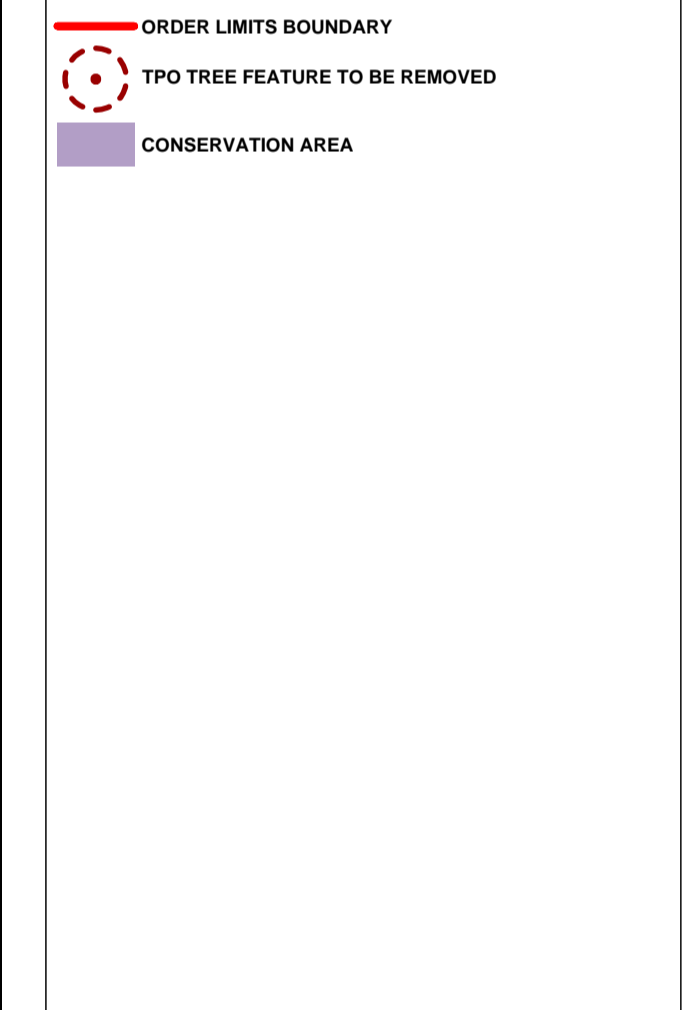

ISSUE/REVISION

NR	DATE	DESCRIPTION
00	22/11/22	FIRST ISSUE

DRAWING STATUS
 SUBMITTED AT DEADLINE 3

PROJECT NUMBER
 60589004

SHEET TITLE
 TREE PRESERVATION ORDER
 TREES LOCATION PLAN
 (SHEET 0)

SHEET NUMBER **REV.**
 60589004-ACM-XX-XX-AB-TPOTLP-00 00

This drawing has been prepared for the use of AECOM's client. It may not be used, modified, reproduced or relied upon by third parties, except as agreed by AECOM or as required by law. AECOM accepts no responsibility and denies any liability whatsoever to any party that uses or relies on this drawing without AECOM's express written consent. Do not scale this document. All measurements must be obtained from the stated dimensions.

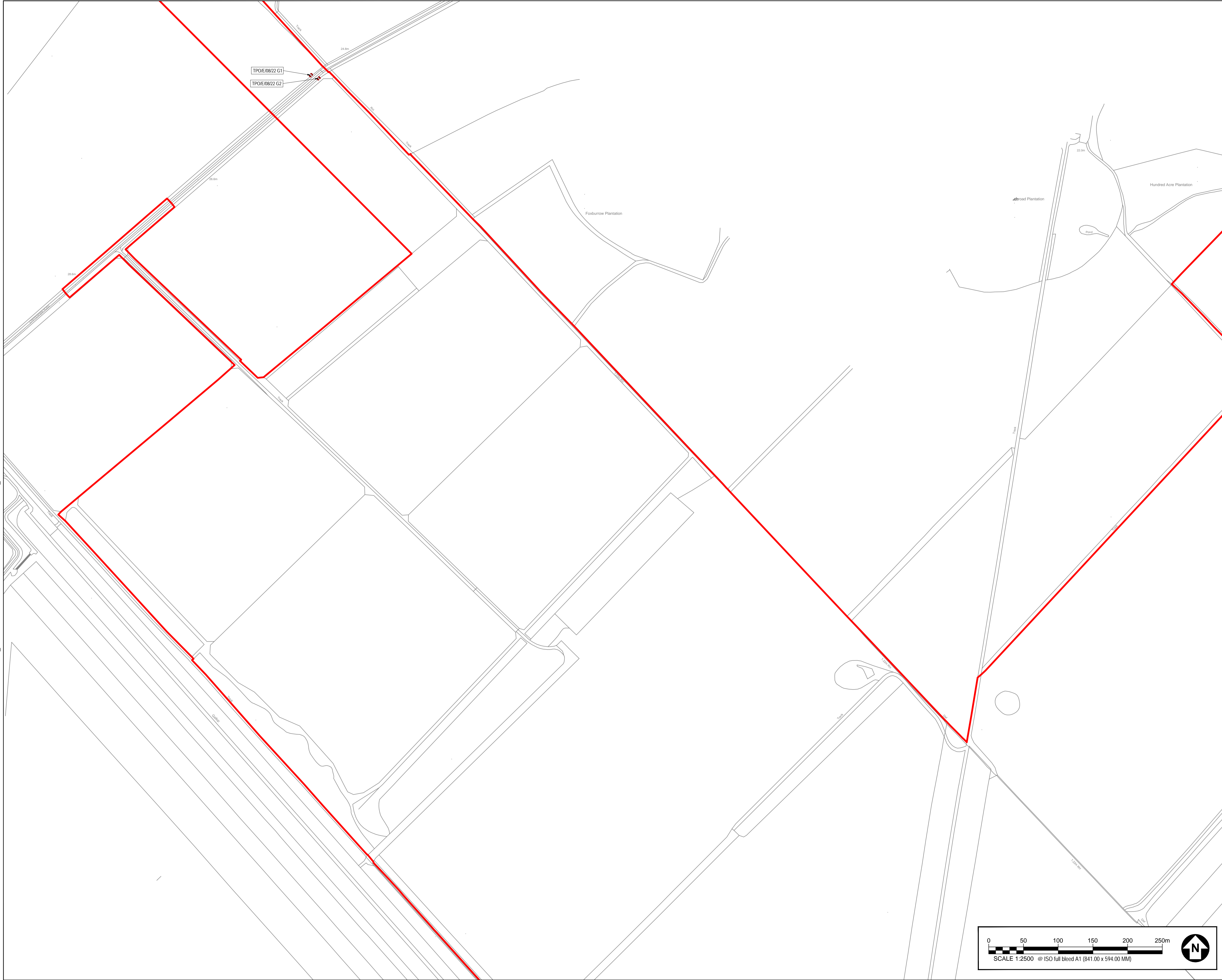

PROJECT
 SUNNICA ENERGY FARM

CLIENT
 SUNNICA ENERGY FARM

CONSULTANT
 AECOM
 Plumer House, Third Floor,
 East Wing, Tallyour Road
 Plymouth, PL6 5DH
 Tel +44(0)1752 676700
 Fax +44(0)870 238 6023
 www.aecom.com

GENERAL NOTES

1. TREE LOCATIONS ARE BASED ON THE TOPOGRAPHICAL SURVEY, AERIAL IMAGERY, AND GPS CO-ORDINATES FROM ON SITE WALKOVER.
2. PLANS SHOULD BE READ IN CONJUNCTION WITH THE AECOM ARBORICULTURAL REPORT.
3. DRAWING REFERENCES:
 ref_082820.dwg

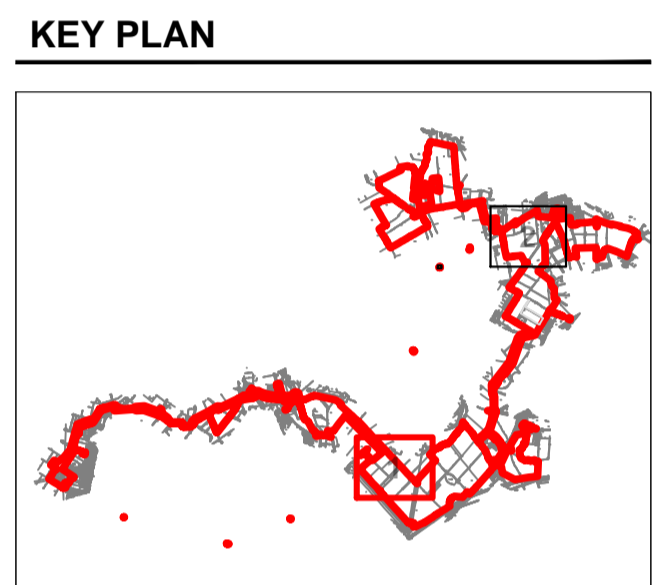

KEY

- ORDER LIMITS BOUNDARY
- TPO TREE FEATURE TO BE REMOVED
- CONSERVATION AREA

ISSUE/REVISION

IR	DATE	DESCRIPTION
00	22/11/22	FIRST ISSUE

DRAWING STATUS
 SUBMITTED AT DEADLINE 3

PROJECT NUMBER
 60589004

SHEET TITLE
 TREE PRESERVATION ORDER
 TREES LOCATION PLAN
 (SHEET 1)

SHEET NUMBER **REV.**
 60589004-ACM-XX-XX-AB-TPOTLP-01 00

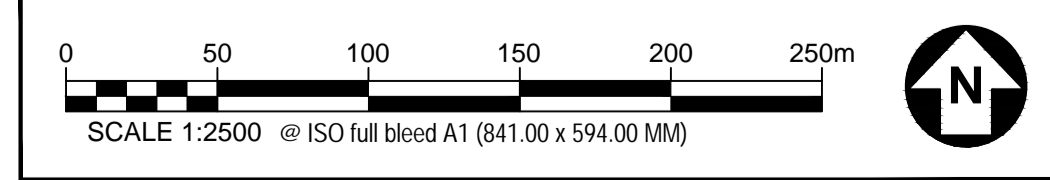

This drawing has been prepared for the use of AECOM's client. It may not be used, modified, reproduced or relied upon by third parties, except as agreed by AECOM or as required by law. AECOM accepts no responsibility and denies any liability whatsoever to any party that uses or relies on this drawing without AECOM's express written consent. Do not scale this document. All measurements must be obtained from the stated dimensions.

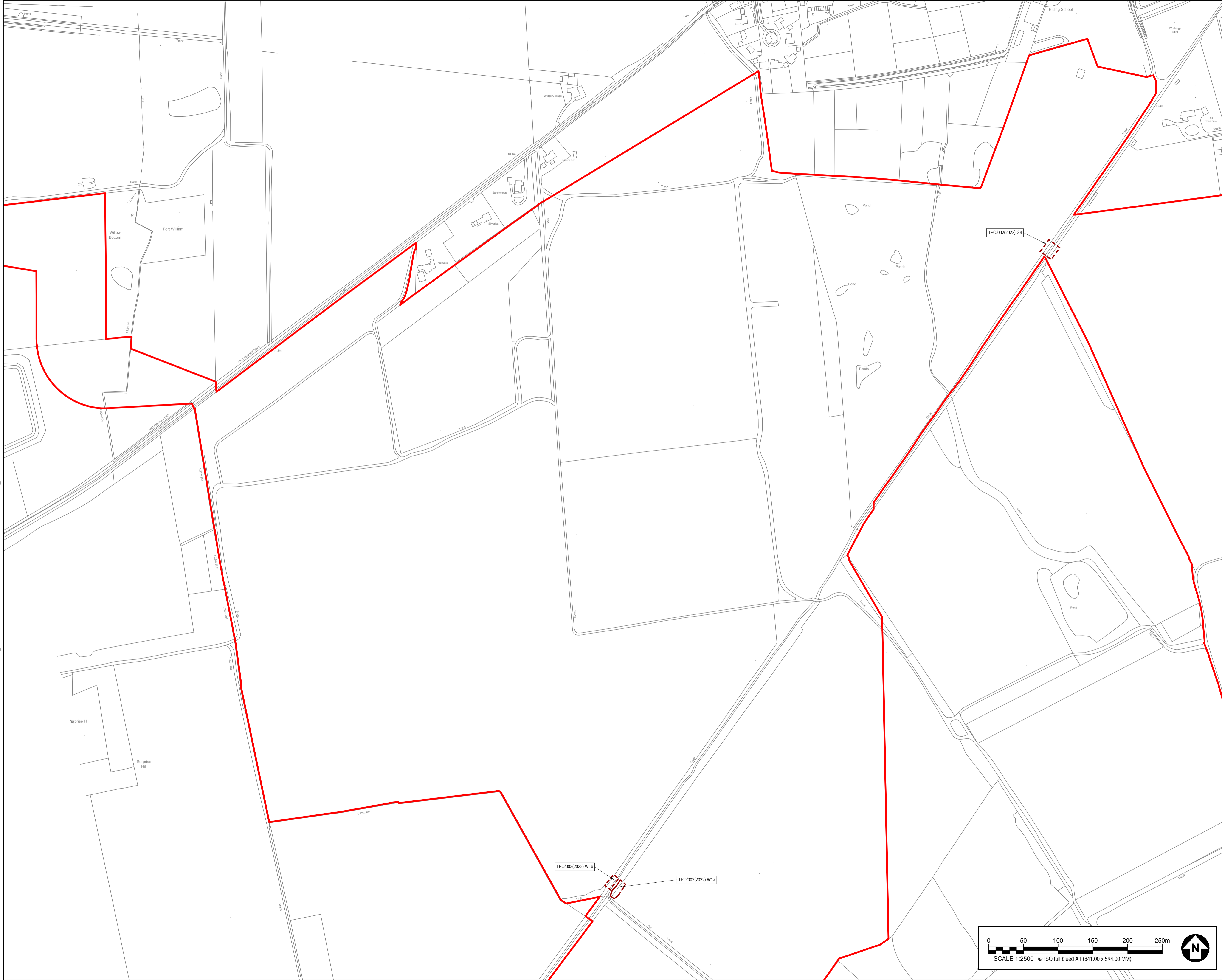

PROJECT
 SUNNICA ENERGY FARM

CLIENT
 SUNNICA ENERGY FARM

CONSULTANT
 AECOM
 Plumer House, Third Floor,
 East Wing, Tallyour Road
 Plymouth, PL6 5DH
 Tel +44(0)1752 676700
 Fax +44(0)1870 238 6023
 www.aecom.com

GENERAL NOTES

1. TREE LOCATIONS ARE BASED ON THE TOPOGRAPHICAL SURVEY, AERIAL IMAGERY, AND GPS CO-ORDINATES FROM ON SITE WALKOVER.
2. PLANS SHOULD BE READ IN CONJUNCTION WITH THE AECOM ARBORICULTURAL REPORT.
3. DRAWING REFERENCES: ref_cadastre.dwg

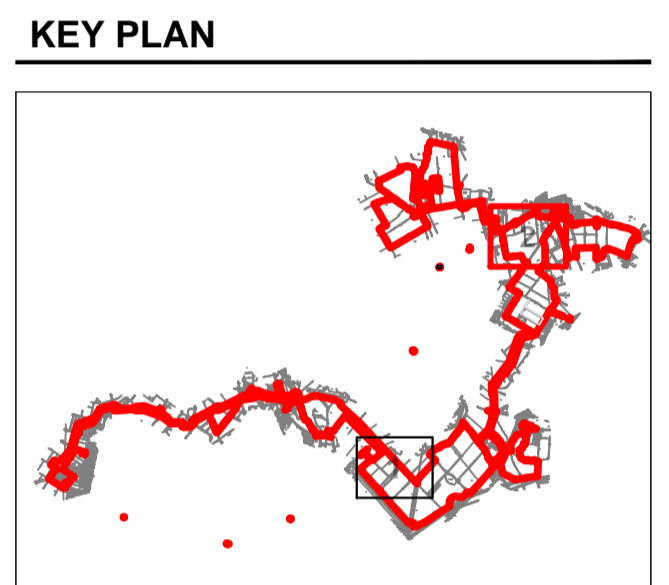

KEY

- ORDER LIMITS BOUNDARY
- TPO TREE FEATURE TO BE REMOVED
- CONSERVATION AREA

ISSUE/REVISION

IR	DATE	DESCRIPTION
00	22/11/22	FIRST ISSUE

DRAWING STATUS
 SUBMITTED AT DEADLINE 3

PROJECT NUMBER
 60589004

SHEET TITLE
 TREE PRESERVATION ORDER
 TREES LOCATION PLAN
 (SHEET 2)

SHEET NUMBER **REV.**
 60589004-ACM-XX-XX-AB-TPOTLP-02 00

This drawing has been prepared for the use of AECOM's client. It may not be used, modified, reproduced or relied upon by third parties, except as agreed by AECOM or as required by law. AECOM accepts no responsibility and denies any liability whatsoever to any party that uses or relies on this drawing without AECOM's express written consent. Do not scale this document. All measurements must be obtained from the stated dimensions.

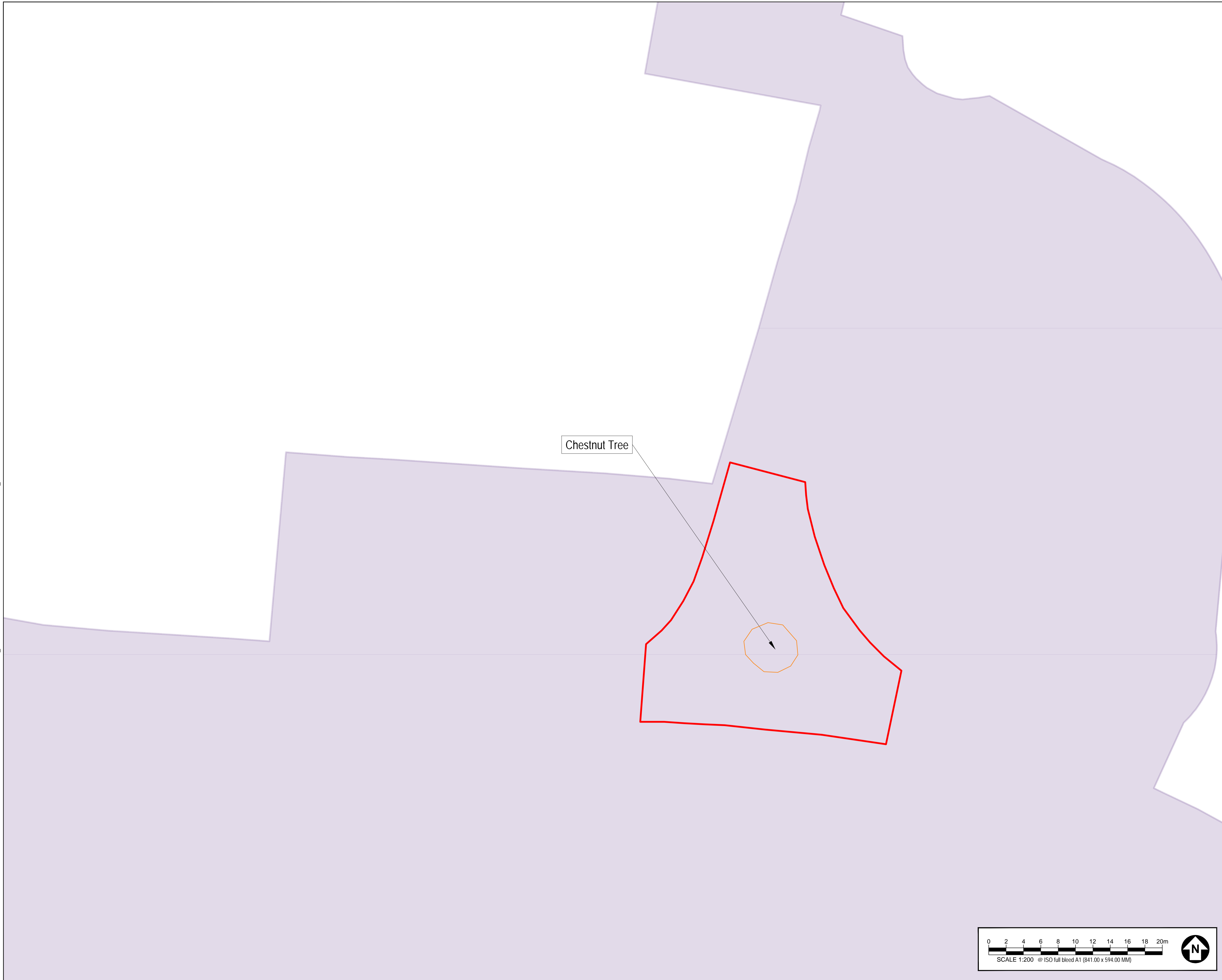

PROJECT
SUNNICA ENERGY FARM

CLIENT
SUNNICA ENERGY FARM

CONSULTANT
AECOM
Plumer House, Third Floor,
East Wing, Tallyour Road
Plymouth, PL6 5DH
Tel +44(0)1752 676700
Fax +44(0)870 238 6023
www.aecom.com

GENERAL NOTES
1. TREE LOCATIONS ARE BASED ON THE TOPOGRAPHICAL SURVEY,
AERIAL IMAGERY, AND GPS CO-ORDINATES FROM ON SITE WALKOVER.
2. PLANS SHOULD BE READ IN CONJUNCTION WITH THE AECOM
ARBORICULTURAL REPORT.
3. DRAWING REFERENCES:
net.cdntrading

KEY PLAN



KEY

- ORDER LIMITS BOUNDARY
- TPO TREE FEATURE TO BE REMOVED
- CONSERVATION AREA

ISSUE/REVISION

IR	DATE	DESCRIPTION
00	22/11/22	FIRST ISSUE

DRAWING STATUS
SUBMITTED AT DEADLINE 3

PROJECT NUMBER
60589004

SHEET TITLE
TREE PRESERVATION ORDER
TREES LOCATION PLAN
(SHEET 3)

SHEET NUMBER **REV.**
60589004-ACM-XX-XX-AB-TPOTLP-03 00

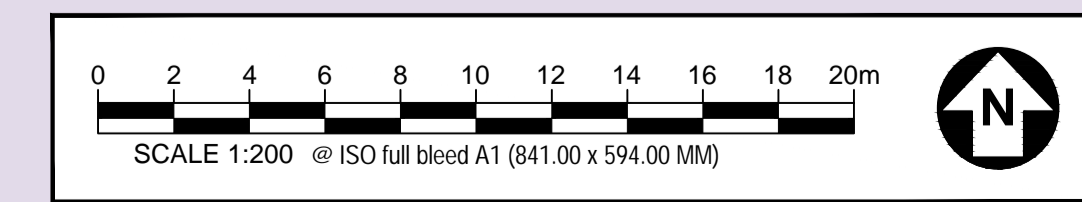

This drawing has been prepared for the use of AECOM's client. It may not be used, modified, reproduced or relied upon by third parties, except as agreed by AECOM or as required by law. AECOM accepts no responsibility and denies any liability whatsoever, to any party that uses or relies on this drawing without AECOM's express written consent. Do not scale this document. All measurements must be obtained from the stated dimensions.